

## Window installation

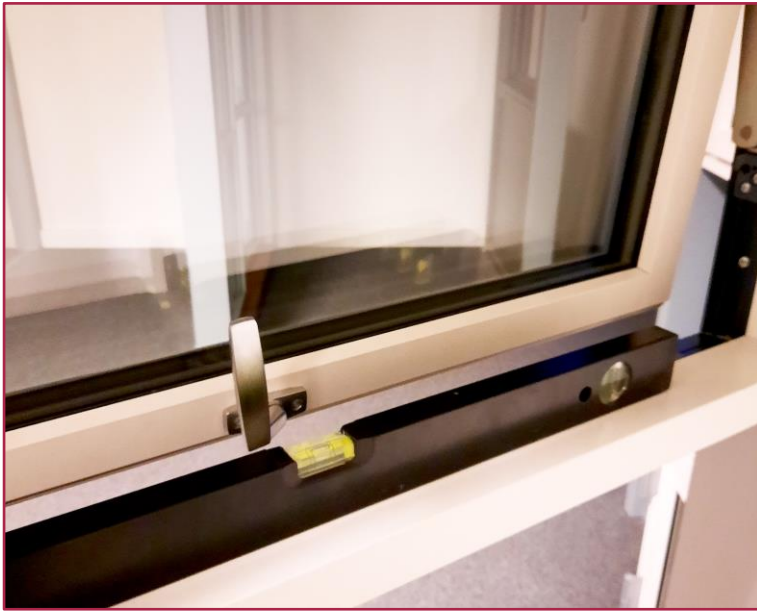

The frame in the hinge side and bottom frame must be plumb and level.  
Air/clearance between sash and frame must be the same all the way around.



**Remember!**  
Mounting screws must be large headed and placed in or as close to the hinges as possible.

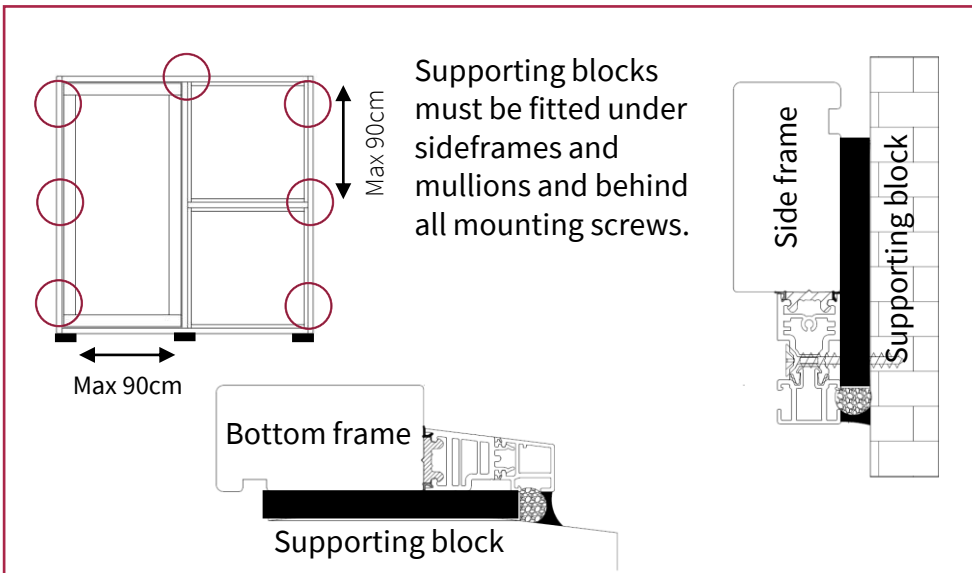
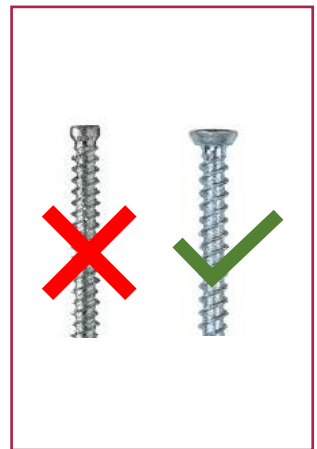

Supporting blocks must be fitted under sideframes and mullions and behind all mounting screws.

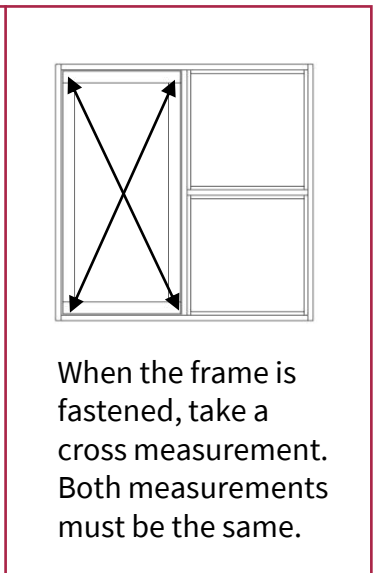

When the frame is fastened, take a cross measurement. Both measurements must be the same.

## Window adjustment

### Topguided

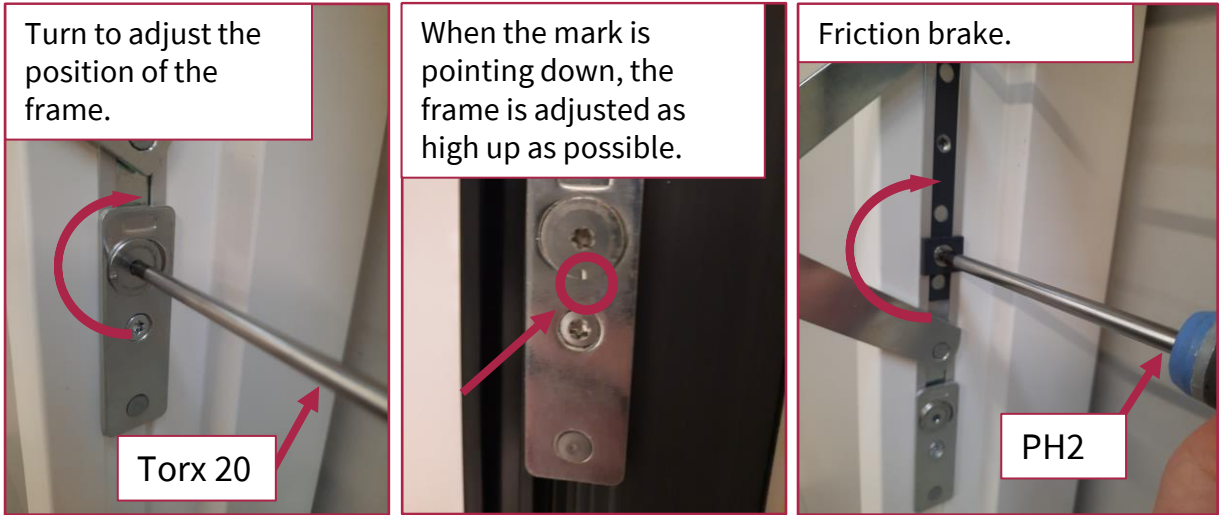

### Side guided/side hung handle operated or with casement fastener.

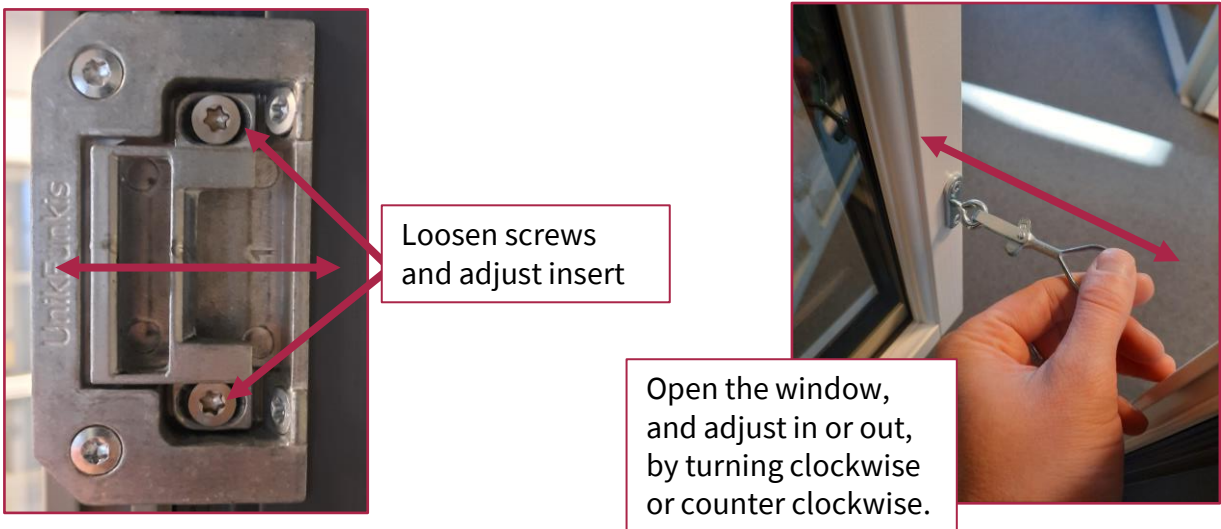

Clean and lubricate moving parts. Use a suitable acid-free oil. This should be done as needed, but at least once a year.